

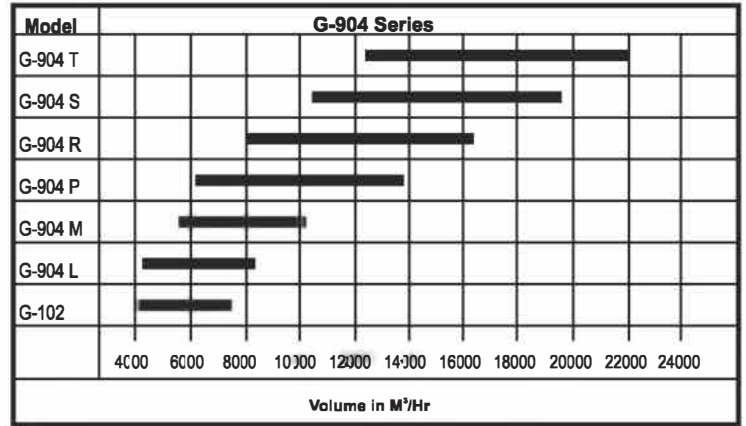

GXL / G-904

**Liquid Ring Vacuum Pumps
& Compressors**

MANUFACTURING RANGE

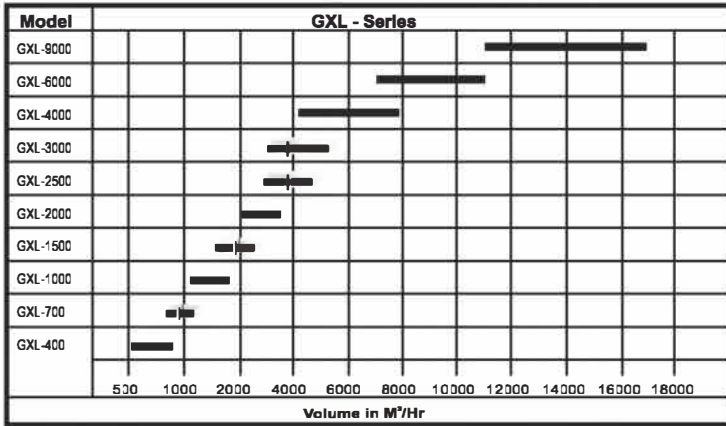

Material Selection Chart

- GX - Standard Cast Iron FG - 260 with Rotor in S.G. Iron / Ductile Iron.
- GXS - Rotor and Control Cones in 304 / 316 Stainless Steel Shaft in 410 SS
- GCSC - Body - Cladded with 316 SS
Head - Cladded with 316 SS
- Optional - 316L, 410 SS, Ph. Bronze, Alloy - 20

Testing Standards :

Each pump is subject to rigorous test runs at our Solid Concrete Test Bed facilities in accordance with HEI Standards for LRVP's (NASH ORIFICE METHOD) / BS 1571 PT - 2 PNEUROPE LTD. Authenticating the Power, Vacuum and Air Displacement Parameters, each pump is certified for its performance.

INFRASTRUCTURE

IN HOUSE STAINLESS STEEL CASTING FOUNDRY & MANUFACTURING FACILITIES



IN HOUSE STATE OF THE ART TEST BED FACILITIES



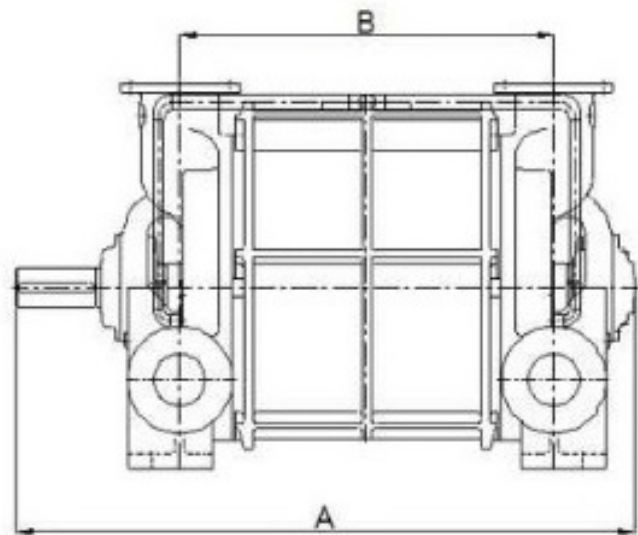
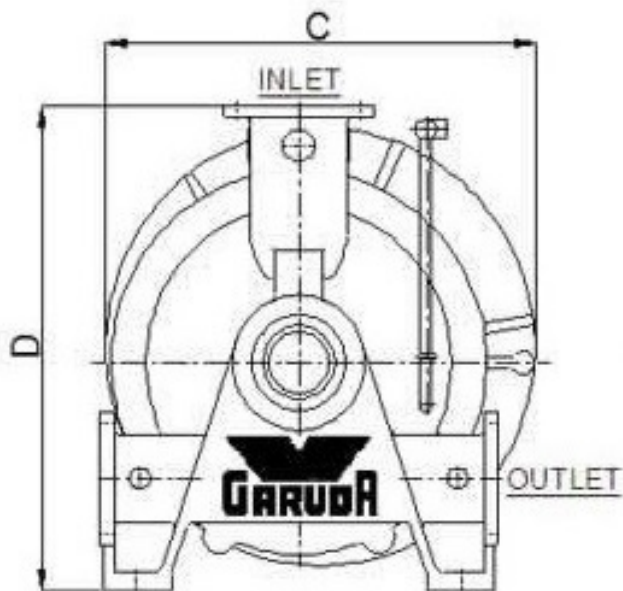

Model	Dim in mm				Flanges	
	A	B	C	D	INLET	OUTLET
GXL-400	902	448	394	483	3"	2.5"
GXL-700	1026	571	495	540	4"	3"
GXL-1000	1216	679	610	660	5"	4"
GXL-2000	1508	908	838	914	6"	5"
GXL-3000	1727	1030	1003	1118	8"	6"
GXL-4000	2050	1314	1210	1245	10"	8"
GXL-6000	2413	1429	1467	1683	12"	10"
GXL-9000	2413	1562	1765	2057	14"	12"